

# Setting Jet-Tech Program and User Properties in Microsoft Vista.

1. Right-click on the Jet-Tech icon, on your Windows Desktop. This will open a small menu from which you should select "Properties". The Window below will open. From the "Compatibility" tab, ensure the "Privilege Level" is checked to "Run this program as an administrator"

2. From the "Security" tab, select your user name to check the Permissions. "Allow" should be ticked for all options as in the screen shot below. If they are not, click on "Edit"

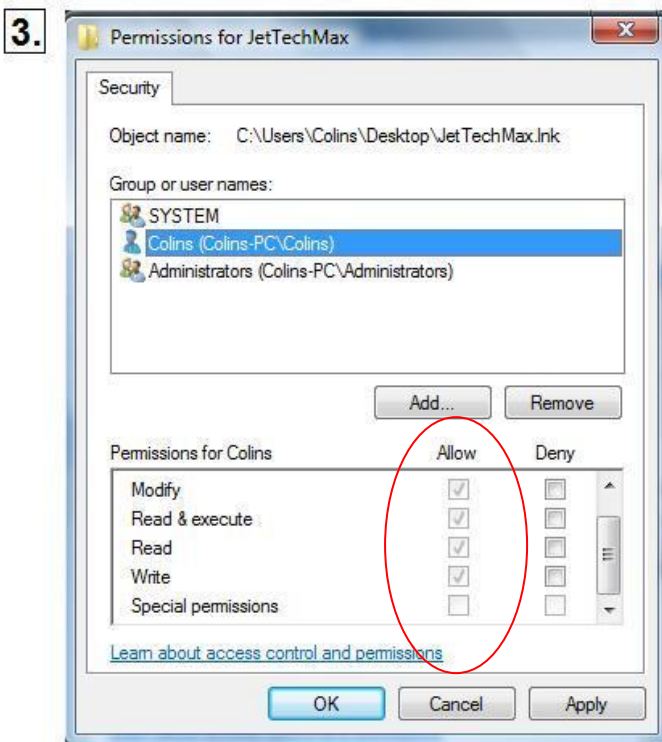
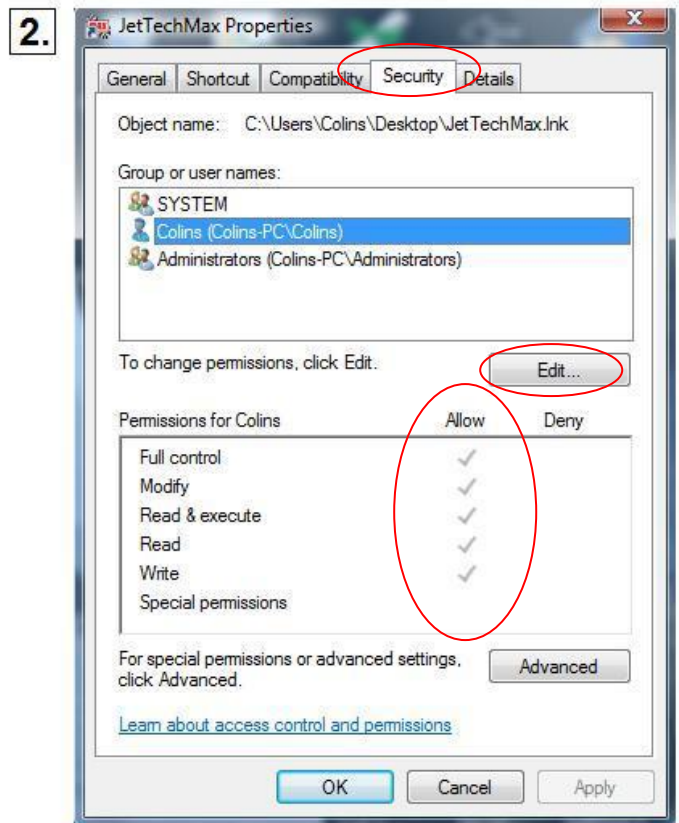
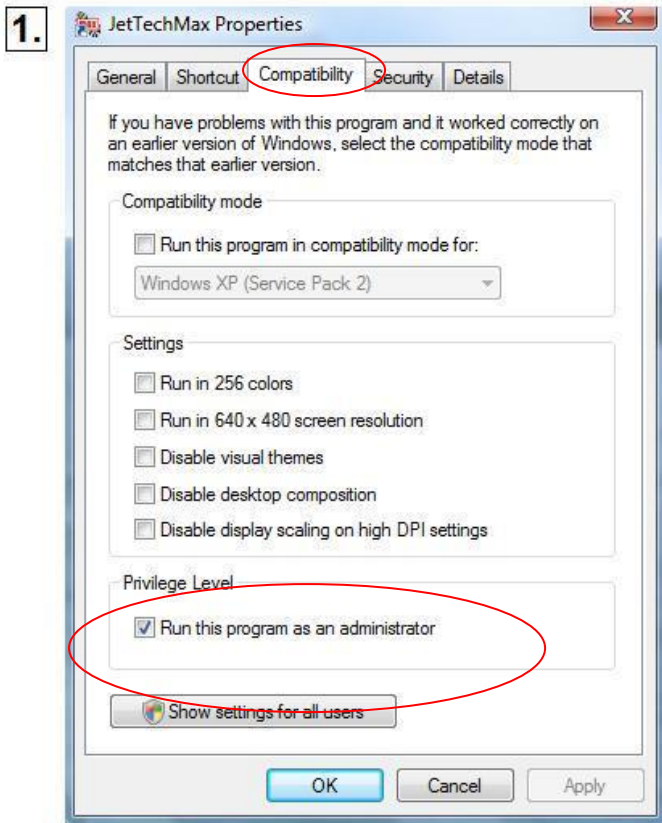

1. In the "Edit" screen (left) tick all the options in the "Allow" column. Then click on "Apply" then "OK".

You have now set the correct privilege levels for your User Profile which should enable you to open and run the Jet-Tech program.

